

HWS 9014

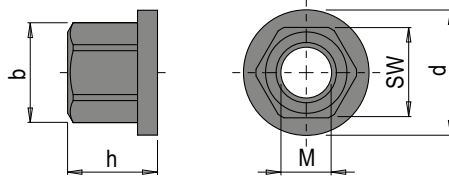

Sechskantmutter mit Bund, geschmiedet, DIN 6331

Hexagon nut with collar, forged, DIN 6331



DIN 6331

b	h	SW	d	FK ¹⁾	M	Nr. / No.
11.05	9	10	14	10	M 6	HWS 9014/ 6
14.4	12	13	18		M 8	HWS 9014/ 8
17.8	15	16	22		M10	HWS 9014/10
20	18	18	25		M12	HWS 9014/12
26.8	24	24	31		M16	HWS 9014/16
30.1	27	27	34		M18	HWS 9014/18
33.5	30	30	37		M20	HWS 9014/20
40	36	36	45		M24	HWS 9014/24

1) FK: Festigkeitsklasse / FK: strength class