

HWS 9013

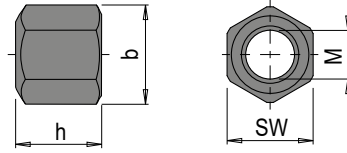

Sechskantmutter, DIN 6330B

Hexagon nut, DIN 6330B



DIN 6330B

b	h	SW	FK ¹⁾	M	Nr. / No.
11.05	9	10	10	M 6	HWS 9013/ 6
14.4	12	13		M 8	HWS 9013/ 8
17.8	15	16		M10	HWS 9013/10
20	18	18		M12	HWS 9013/12
26.8	24	24		M16	HWS 9013/16
30.1	27	27		M18	HWS 9013/18
33.5	30	30		M20	HWS 9013/20
40	36	36		M24	HWS 9013/24

1) FK: Festigkeitsklasse / FK: strength class