

E 65740



Logikverteiler für Sensorik, einfach UND/ODER

Logic distributor for sensors, single AND/OR

M12x1 - Stecker 4-polig
M12x1 - Male connector 4-poles

M8x1 - Buchse 3-polig
M8x1 - Female connector 3-poles

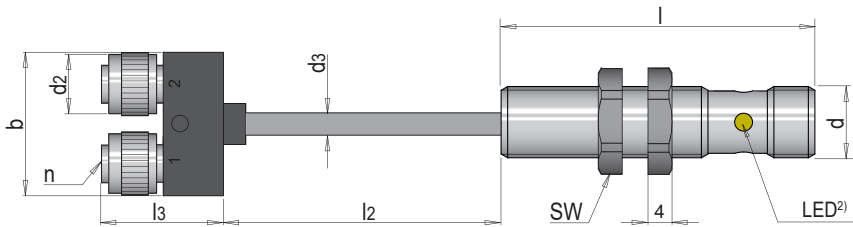

PIN1 = +
PIN2 = ODER / OR (S1-S2)
PIN3 = -
PIN4 = UND / AND (S1-S2)



PIN1 = +
PIN3 = -
PIN4 = Signal (S)

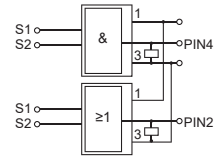

t max. = 70°C

b	l	l2	l3	d3	SW	d	Pole d / Poles d	d2	Pole d2 / Poles d2	n ¹⁾	Nr. / No.
34	60	300	23	4.4	17	M12x1	4	M8x1	3	1x2	E 65740/8/3/1x2

Betriebsspannung / Operating voltage	12 - 30 V DC
Maximaler Summenstrom / Maximum total current	200 mA
Maximaler Ausgangsstrom UND/ODER / Maximum output current AND/OR für Ausgabeart / type for output	100 mA PNP
Schutzart / Protection class	IP67
Maximale Temperatur / Maximum temperature	70 °C
Spannungsabfall / Voltage drop	Nein / No
Signalzusammenführung UND / Signal merger AND	1x2...2 Signale / signals
Kabel / Cable	PUR
Schaltpegel Low/High / Switching levels low / high	<5V / >11V

ANWENDUNGSBEISPIEL:

EXAMPLE OF USE:

Anschlussmöglichkeiten:

Näherungsschalter,
Magnetfeldsensoren, Lichtschranken,
usw.

Connection options:

Proximity switch, Magnetic proximity
sensor, Light barrier, etc.

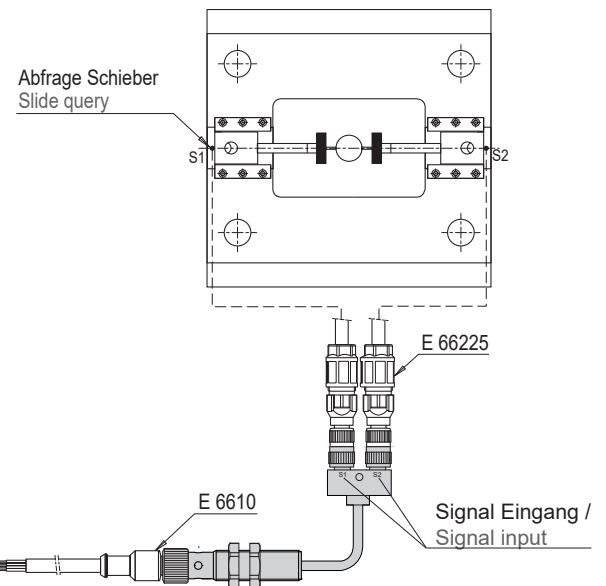

1) n: Anzahl Anschlüsse / n: Number of terminals

2) LED: Betriebszustandsanzeige / LED: Operating states indicator

Signal Ausgang / Signal output

schwarz / black PIN4 = UND/AND (S1-S2)
weiß / white PIN2 = ODER/OR (S1-S2)