

E 6116 ST



Gleitplatte Stahl, VDI 3357

Wear plate, steel, VDI 3357

S
20 mm

Mat.: 1.7131

58 - 60 HRC

VDI 3357

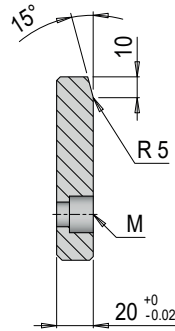
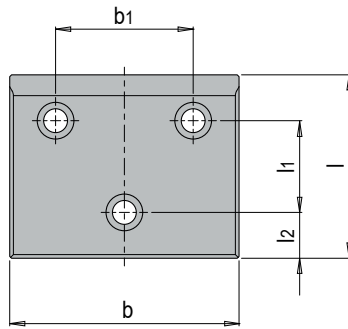

Form A
Shape A

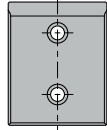

Form B
Shape B

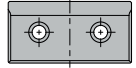

Form C
Shape C

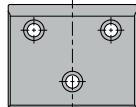

Form / Shape	M	l1	b1	l2	b	l	Nr. / No.	
A	M12	50	-	25	50	100	E 6116ST/ 50x100	
		75				125	E 6116ST/ 50x125	
		110				160	E 6116ST/ 50x160	
B	M 8	-	30	-	80	50	E 6116ST/ 80x 50	
A	M12	30	-			-	80	E 6116ST/ 80x 80
		50					100	E 6116ST/ 80x100
		75		125	E 6116ST/ 80x125			
		110		160	E 6116ST/ 80x160			
B	-	150	50	-	100	200	E 6116ST/ 80x200	
		-				50	E 6116ST/100x 50	
		80				80	E 6116ST/100x 80	
A	-	50	-	40	100	100	E 6116ST/100x100	
		75		25		125	E 6116ST/100x125	
		110		25		160	E 6116ST/100x160	
		150		25		200	E 6116ST/100x200	
B	-	170	50	40	125	250	E 6116ST/100x250	
		-		25		50	E 6116ST/125x 50	
		40		80		E 6116ST/125x 80		
C	-	50	-	25	100	100	E 6116ST/125x100	
		75				125	E 6116ST/125x125	
		110				160	E 6116ST/125x160	
		150				200	E 6116ST/125x200	
		75				110	125	E 6116ST/160x125
		110					160	E 6116ST/160x160
150	200	E 6116ST/160x200						