

E 2084

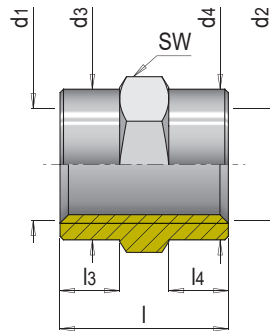

Muffe

Socket

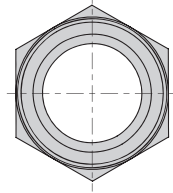

Mat.: 2.0401 (CuZn), vernickelt / nickel-plated

p max. = 16 bar

SW	l	d3	l3	d4	l4	d1	d2	Nr. / No.
14	15	13.5	4.5	13.5	4.5	G 1/8"	G 1/8"	E 2084/1/8/1/8
17	19.5	16.5	7	16.5	5.5	G 1/4"	G 1/4"	E 2084/1/4/1/8
	7				E 2084/1/4/1/4			
22	21	21.5	7.5	17	8	G 3/8"	G 3/8"	E 2084/3/8/1/4
	23							E 2084/3/8/3/8
27	28.5	26.5	10	26.5	10	G 1/2"	G 1/2"	E 2084/1/2/1/2
32	29	31.5		31.5		G 3/4"	G 3/4"	E 2084/3/4/3/4

## ANWENDUNGSBEISPIEL: VERSCHIEDENE ADAPTER

APPLICATION EXAMPLE: DIFFERENT ADAPTERS

