

## E 17109



Auswerferstift rostfrei, gehärtet

Ejector pin, stainless steel, through-hardened

- » Ideal für Reinraum
- » Für korrosive & chemisch aggressive Kunststoffe
- » Ideal for use in cleanrooms
- » For corrosive and chemically aggressive plastics

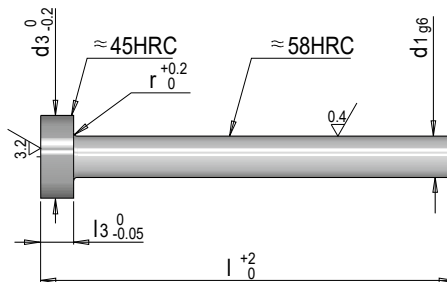

≈ ISO 6751 (DIN 1530 A)  
Form AH

Mat.: ~1.4112

r	l3	d3	d1	l	Nr. / No.
0.2	1.2	2.5	1	125	E 17109/ 1 x 125
0.2	1.5	3	1.5	250	E 17109/ 1,5 x 250
0.2	2	4	2	125	E 17109/ 2 x 125
				200	E 17109/ 2 x 200
0.3	2	5	2.5	100	E 17109/ 2,5 x 100
				160	E 17109/ 2,5 x 160
				250	E 17109/ 2,5 x 250
0.3	3	6	3	125	E 17109/ 3 x 125
				200	E 17109/ 3 x 200
				315	E 17109/ 3 x 315
0.3	3	7	3.5	100	E 17109/ 3,5 x 100
				160	E 17109/ 3,5 x 160
				250	E 17109/ 3,5 x 250
0.3	3	8	4	125	E 17109/ 4 x 125
				200	E 17109/ 4 x 200
				315	E 17109/ 4 x 315
0.3	3	8	4.5	100	E 17109/ 4,5 x 100
				160	E 17109/ 4,5 x 160
				250	E 17109/ 4,5 x 250
0.3	3	10	5	125	E 17109/ 5 x 125
				200	E 17109/ 5 x 200
				315	E 17109/ 5 x 315
0.3	3	10	5.5	100	E 17109/ 5,5 x 100
				160	E 17109/ 5,5 x 160
				250	E 17109/ 5,5 x 250
0.5	5	12	6	125	E 17109/ 6 x 125
				200	E 17109/ 6 x 200
				315	E 17109/ 6 x 315
0.5	5	14	8	125	E 17109/ 8 x 125
				200	E 17109/ 8 x 200
				315	E 17109/ 8 x 315
0.5	5	16	10	100	E 17109/10 x 100
				160	E 17109/10 x 160
				250	E 17109/10 x 250
0.8	7	18	12	100	E 17109/12 x 100
				160	E 17109/12 x 160
				250	E 17109/12 x 250