

E 1316



Gleitteil für Flachführung, vertikal

Gliding part for flat guiding unit, vertical

- » Abnehmbare Gleitplatte W-C-H beschichtet
- » Einbau durch vertikale Bearbeitung von der Trennebene aus
- » Removable, W-C:H coated sliding plates
- » Easy installation through vertical machining from the split line face

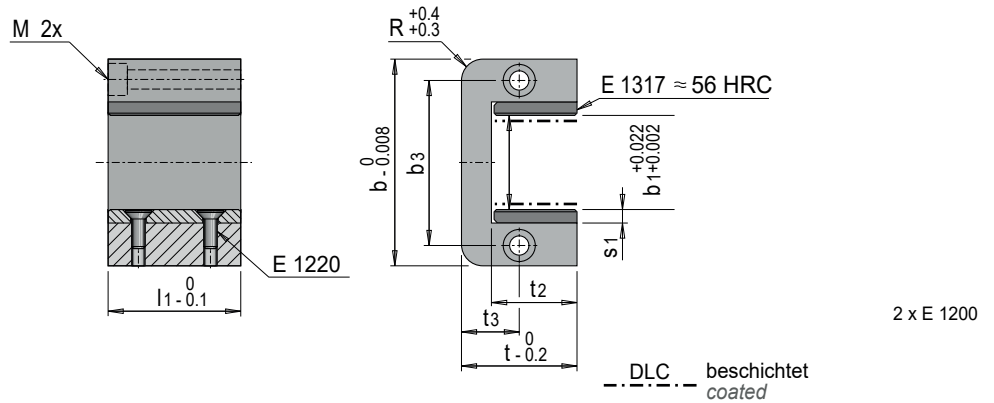

Mat.: 1.1730 $\approx 640 \text{ N/mm}^2$

b	b3	l1	t	t2	t3	R	M	b1	s1	Nr. / No.	b1	Nr. / No.
74	60	44	40	30.5	20	8	M 6	32	6	E 1316/32/ 6	34	E 1316/34/ 6
									6.2	E 1316/32/ 6,2		E 1316/34/ 6,2
96	77	62	50	38.8	25	10	M 8	44	6	E 1316/44/ 6	46	E 1316/46/ 6
									6.2	E 1316/44/ 6,2		E 1316/46/ 6,2
124	100	80	66	51.2	33	12	M10	58	8	E 1316/58/ 8	60	E 1316/60/ 8
									8.3	E 1316/58/ 8,3		E 1316/60/ 8,3
152	126	98	88	71.6	44	16	M12	78	10	E 1316/78/10	80	E 1316/80/10
									10.3	E 1316/78/10,3		E 1316/80/10,3

