

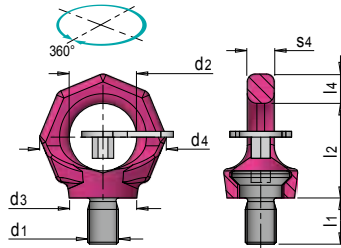

PRODUCT DESCRIPTION

- » Loadable in any direction
- » Safety factor 4:1
- » Tool-free installation through captive key plate
- » All load-bearing parts are 100% crack tested and proof load tested according to EN 1677



| l1 | l2 | l4 | d2 | d3 | d4 | s4 | d1 | WLL | | | | No. | EUR |
|----|-----|----|----|-----|-----|----|------------|---------|---------|---------|---------|-----------|-----|
| | | | | | | | | max. kg | max. kg | max. kg | max. kg | | |
| 9 | 28 | 9 | 20 | 23 | 37 | 7 | M 6 | 500 | 100 | 200 | 140 | E 1272/ 6 | <> |
| 12 | 35 | 11 | 25 | 25 | 47 | 9 | M 8 | 1,000 | 300 | 600 | 420 | E 1272/ 8 | <> |
| 15 | 35 | 11 | 25 | 25 | 47 | 9 | M10 | 1,000 | 400 | 800 | 560 | E 1272/10 | <> |
| 18 | 42 | 13 | 30 | 30 | 56 | 10 | M12 | 2,000 | 750 | 1,500 | 1,000 | E 1272/12 | <> |
| 24 | 49 | 15 | 35 | 36 | 65 | 13 | M16 | 4,000 | 1,500 | 3,000 | 2,120 | E 1272/16 | <> |
| 30 | 58 | 17 | 40 | 41 | 76 | 16 | M20 | 6,000 | 2,300 | 4,600 | 3,220 | E 1272/20 | <> |
| 36 | 70 | 20 | 49 | 51 | 92 | 19 | M24 | 8,000 | 3,200 | 6,400 | 4,500 | E 1272/24 | <> |
| 45 | 87 | 26 | 60 | 66 | 114 | 24 | M30 | 12,000 | 4,500 | 9,000 | 6,300 | E 1272/30 | <> |
| 54 | 103 | 32 | 72 | 76 | 135 | 29 | M36 | 16,000 | 7,000 | 14,000 | 9,800 | E 1272/36 | <> |
| 63 | 121 | 37 | 84 | 86 | 158 | 33 | M42 | 24,000 | 9,000 | 18,000 | 12,600 | E 1272/42 | <> |
| 72 | 138 | 42 | 94 | 100 | 180 | 42 | M48 | 32,000 | 12,000 | 24,000 | 16,800 | E 1272/48 | <> |

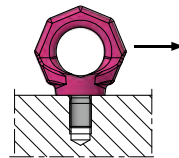

- Do not rotate under load!
- Rotate in the direction of force before loading!
- Hand tighten, do not use extension!