

E 1160



Zentrierhülse mit zwei Passdurchmessern

Centring bush with two fitting diameters

» Mit Presssitz für festen Halt

» Press fit for firm, secure installation of the bush

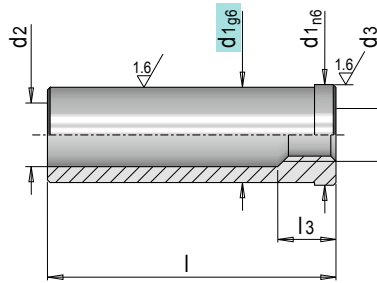

Mat.: 1.7131 ≈ 60 HRC

l3	d2	d3	d1	l	Nr. / No.				
8	11	M 8	14	20	E 1160/14 x 20				
				30	E 1160/14 x 30				
				40	E 1160/14 x 40				
				50	E 1160/14 x 50				
				60	E 1160/14 x 60				
				70	E 1160/14 x 70				
				80	E 1160/14 x 80				
				100	E 1160/14 x 100				
				14	16	M12	20	30	E 1160/20 x 30
								40	E 1160/20 x 40
50	E 1160/20 x 50								
60	E 1160/20 x 60								
70	E 1160/20 x 70								
80	E 1160/20 x 80								
90	E 1160/20 x 90								
100	E 1160/20 x 100								
14	21	M12	26					30	E 1160/26 x 30
								40	E 1160/26 x 40
				50	E 1160/26 x 50				
				60	E 1160/26 x 60				
				70	E 1160/26 x 70				
				80	E 1160/26 x 80				
				90	E 1160/26 x 90				
				100	E 1160/26 x 100				
				14	25	M12	30	40	E 1160/30 x 40
								50	E 1160/30 x 50
60	E 1160/30 x 60								
70	E 1160/30 x 70								
80	E 1160/30 x 80								
90	E 1160/30 x 90								
100	E 1160/30 x 100								
110	E 1160/30 x 110								
18	33	M12	42					40	E 1160/42 x 40
								60	E 1160/42 x 60
				80	E 1160/42 x 80				
				100	E 1160/42 x 100				
				120	E 1160/42 x 120				
				140	E 1160/42 x 140				
				160	E 1160/42 x 160				
				180	E 1160/42 x 180				
				200	E 1160/42 x 200				
				220	E 1160/42 x 220				
18	33	M12	42	240	E 1160/42 x 240				
				280	E 1160/42 x 280				

l3	d2	d3	d1	l	Nr. / No.
18	43	M12	54	60	E 1160/54 x 60
				80	E 1160/54 x 80
				100	E 1160/54 x 100
				120	E 1160/54 x 120
				160	E 1160/54 x 160
				180	E 1160/54 x 180
				200	E 1160/54 x 200
				220	E 1160/54 x 220
				240	E 1160/54 x 240
				260	E 1160/54 x 260
26	54	M12	66	80	E 1160/66 x 80
				120	E 1160/66 x 120
				160	E 1160/66 x 160
				180	E 1160/66 x 180
				200	E 1160/66 x 200
				220	E 1160/66 x 220
				240	E 1160/66 x 240
				260	E 1160/66 x 260
				280	E 1160/66 x 280
				300	E 1160/66 x 300
26	54	M12	66	320	E 1160/66 x 320
				360	E 1160/66 x 360
				380	E 1160/66 x 380