

## E 1115



### Führungsbuchse ohne Zentrierbund wartungsfrei

Guide bush without centring collar, self lubricating

- » Graphiteinsätze für lebenslange Schmierung
- » Inklusive Seegerring-Einstich für E 1575
- » Graphite inserts for permanent lubrication
- » With groove for the E 1575 Circlip

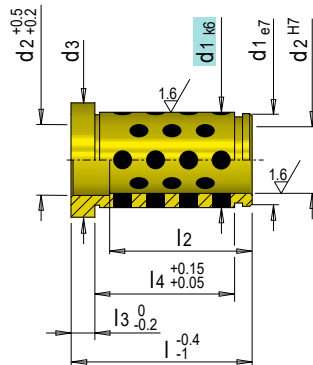

Mat.: 2.0598

≈ 200 HB / Graphit / graphite

t max. = 200°C

| l2 <sup>1)</sup> | l3 | l4   | d3 | d1 | d2 | l   | Nr. / No.       | d2 | Nr. / No.       | l2 <sup>1)</sup> | l3  | l4  | d3 | d1 | d2 | l   | Nr. / No.       | d2 | Nr. / No.       |
|------------------|----|------|----|----|----|-----|-----------------|----|-----------------|------------------|-----|-----|----|----|----|-----|-----------------|----|-----------------|
| -                | 3  | 5.5  | 16 | 14 | 9  | 12  | E 1115/ 9 - 12  | 10 | E 1115/10 - 12  | -                | 10  | 58  | 59 | 54 | 40 | 76  | E 1115/40 - 76  | 42 | E 1115/42 - 76  |
|                  |    | 10.5 |    |    |    | 17  | E 1115/ 9 - 17  |    | E 1115/10 - 17  |                  |     | 68  |    |    |    | 86  | E 1115/40 - 86  |    | E 1115/42 - 86  |
|                  |    | 15.5 |    |    |    | 22  | E 1115/ 9 - 22  |    | E 1115/10 - 22  |                  |     | 78  |    |    |    | 96  | E 1115/40 - 96  |    | E 1115/42 - 96  |
|                  |    | 20.5 |    |    |    | 27  | E 1115/ 9 - 27  |    | E 1115/10 - 27  |                  |     | 98  |    |    |    | 116 | E 1115/40 - 116 |    | E 1115/42 - 116 |
|                  |    | 29.5 |    |    |    | 36  | E 1115/ 9 - 36  |    | E 1115/10 - 36  |                  |     | 118 |    |    |    | 136 | E 1115/40 - 136 |    | E 1115/42 - 136 |
|                  | 24 | 39.5 |    |    |    | 46  | E 1115/ 9 - 46  |    | E 1115/10 - 46  |                  |     | 138 |    |    |    | 156 | E 1115/40 - 156 |    | E 1115/42 - 156 |
|                  |    | 49.5 |    |    |    | 56  | E 1115/ 9 - 56  |    | E 1115/10 - 56  |                  |     | 158 |    |    |    | 176 | E 1115/40 - 176 |    | E 1115/42 - 176 |
|                  |    |      |    |    |    |     |                 |    |                 |                  |     | 178 |    |    |    | 196 | E 1115/40 - 196 |    | E 1115/42 - 196 |
|                  | 6  | 7    | 23 | 18 | 12 | 17  | E 1115/12 - 17  | -  |                 | -                | 10  | 38  | 71 | 66 | 50 | 56  | E 1115/50 - 56  | 52 | E 1115/52 - 56  |
|                  |    | 12   |    |    |    | 22  | E 1115/12 - 22  |    |                 |                  |     | 48  |    |    |    | 66  | E 1115/50 - 66  |    | E 1115/52 - 66  |
|                  |    | 17   |    |    |    | 27  | E 1115/12 - 27  |    |                 |                  |     | 58  |    |    |    | 76  | E 1115/50 - 76  |    | E 1115/52 - 76  |
|                  |    | 26   |    |    |    | 36  | E 1115/12 - 36  |    |                 |                  |     | 68  |    |    |    | 86  | E 1115/50 - 86  |    | E 1115/52 - 86  |
|                  | 24 | 36   |    |    |    | 46  | E 1115/12 - 46  |    |                 |                  |     | 78  |    |    |    | 96  | E 1115/50 - 96  |    | E 1115/52 - 96  |
|                  |    | 46   |    |    |    | 56  | E 1115/12 - 56  |    |                 |                  |     | 98  |    |    |    | 116 | E 1115/50 - 116 |    | E 1115/52 - 116 |
|                  | 6  | 7    | 25 | 20 | 14 | 17  | E 1115/14 - 17  | 15 | E 1115/15 - 17  |                  | 104 | 98  |    |    |    | 136 | E 1115/50 - 136 |    | E 1115/52 - 136 |
|                  |    | 12   |    |    |    | 22  | E 1115/14 - 22  |    | E 1115/15 - 22  |                  |     | 118 |    |    |    | 156 | E 1115/50 - 156 |    | E 1115/52 - 156 |
|                  |    | 17   |    |    |    | 27  | E 1115/14 - 27  |    | E 1115/15 - 27  |                  |     | 138 |    |    |    | 176 | E 1115/50 - 176 |    | E 1115/52 - 176 |
|                  |    | 26   |    |    |    | 36  | E 1115/14 - 36  |    | E 1115/15 - 36  |                  |     | 158 |    |    |    | 196 | E 1115/50 - 196 |    | E 1115/52 - 196 |
|                  | 24 | 36   |    |    |    | 46  | E 1115/14 - 46  |    | E 1115/15 - 46  |                  |     | 178 |    |    |    | 216 | E 1115/50 - 216 |    | E 1115/52 - 216 |
|                  |    | 46   |    |    |    | 56  | E 1115/14 - 56  |    | E 1115/15 - 56  |                  |     | 198 |    |    |    | 236 | E 1115/50 - 236 |    | E 1115/52 - 236 |
|                  |    | 56   |    |    |    | 66  | E 1115/14 - 66  |    | E 1115/15 - 66  |                  |     | 218 |    |    |    | 256 | E 1115/50 - 256 |    | E 1115/52 - 256 |
|                  |    | 66   |    |    |    | 76  | E 1115/14 - 76  |    | E 1115/15 - 76  |                  |     | 238 |    |    |    |     |                 |    |                 |
|                  | 6  | 7    | 27 | 22 | 16 | 17  | E 1115/16 - 17  | -  |                 |                  |     |     |    |    |    |     |                 |    |                 |
|                  |    | 12   |    |    |    | 22  | E 1115/16 - 22  |    |                 |                  |     |     |    |    |    |     |                 |    |                 |
|                  |    | 17   |    |    |    | 27  | E 1115/16 - 27  |    |                 |                  |     |     |    |    |    |     |                 |    |                 |
|                  |    | 26   |    |    |    | 36  | E 1115/16 - 36  |    |                 |                  |     |     |    |    |    |     |                 |    |                 |
|                  | 32 | 36   |    |    |    | 46  | E 1115/16 - 46  |    |                 |                  |     |     |    |    |    |     |                 |    |                 |
|                  |    | 46   |    |    |    | 56  | E 1115/16 - 56  |    |                 |                  |     |     |    |    |    |     |                 |    |                 |
|                  |    | 56   |    |    |    | 66  | E 1115/16 - 66  |    |                 |                  |     |     |    |    |    |     |                 |    |                 |
|                  |    | 66   |    |    |    | 76  | E 1115/16 - 76  |    |                 |                  |     |     |    |    |    |     |                 |    |                 |
|                  |    | 76   |    |    |    | 86  | E 1115/16 - 86  |    |                 |                  |     |     |    |    |    |     |                 |    |                 |
|                  | 6  | 7    | 31 | 26 | 18 | 17  | E 1115/18 - 17  | 20 | E 1115/20 - 17  |                  |     |     |    |    |    |     |                 |    |                 |
|                  |    | 12   |    |    |    | 22  | E 1115/18 - 22  |    | E 1115/20 - 22  |                  |     |     |    |    |    |     |                 |    |                 |
|                  |    | 17   |    |    |    | 27  | E 1115/18 - 27  |    | E 1115/20 - 27  |                  |     |     |    |    |    |     |                 |    |                 |
|                  |    | 26   |    |    |    | 36  | E 1115/18 - 36  |    | E 1115/20 - 36  |                  |     |     |    |    |    |     |                 |    |                 |
|                  | 40 | 36   |    |    |    | 46  | E 1115/18 - 46  |    | E 1115/20 - 46  |                  |     |     |    |    |    |     |                 |    |                 |
|                  |    | 46   |    |    |    | 56  | E 1115/18 - 56  |    | E 1115/20 - 56  |                  |     |     |    |    |    |     |                 |    |                 |
|                  |    | 56   |    |    |    | 66  | E 1115/18 - 66  |    | E 1115/20 - 66  |                  |     |     |    |    |    |     |                 |    |                 |
|                  |    | 66   |    |    |    | 76  | E 1115/18 - 76  |    | E 1115/20 - 76  |                  |     |     |    |    |    |     |                 |    |                 |
|                  |    | 76   |    |    |    | 86  | E 1115/18 - 86  |    | E 1115/20 - 86  |                  |     |     |    |    |    |     |                 |    |                 |
|                  | 6  | 11   | 35 | 30 | 22 | 22  | E 1115/22 - 22  | 24 | E 1115/24 - 22  |                  |     |     |    |    |    |     |                 |    |                 |
|                  |    | 16   |    |    |    | 27  | E 1115/22 - 27  |    | E 1115/24 - 27  |                  |     |     |    |    |    |     |                 |    |                 |
|                  |    | 25   |    |    |    | 36  | E 1115/22 - 36  |    | E 1115/24 - 36  |                  |     |     |    |    |    |     |                 |    |                 |
|                  |    | 35   |    |    |    | 46  | E 1115/22 - 46  |    | E 1115/24 - 46  |                  |     |     |    |    |    |     |                 |    |                 |
|                  | 48 | 45   |    |    |    | 56  | E 1115/22 - 56  |    | E 1115/24 - 56  |                  |     |     |    |    |    |     |                 |    |                 |
|                  |    | 55   |    |    |    | 66  | E 1115/22 - 66  |    | E 1115/24 - 66  |                  |     |     |    |    |    |     |                 |    |                 |
|                  |    | 65   |    |    |    | 76  | E 1115/22 - 76  |    | E 1115/24 - 76  |                  |     |     |    |    |    |     |                 |    |                 |
|                  |    | 75   |    |    |    | 86  | E 1115/22 - 86  |    | E 1115/24 - 86  |                  |     |     |    |    |    |     |                 |    |                 |
|                  |    | 85   |    |    |    | 96  | E 1115/22 - 96  |    | E 1115/24 - 96  |                  |     |     |    |    |    |     |                 |    |                 |
|                  | 6  | 14   | 47 | 42 | 30 | 27  | E 1115/30 - 27  | 32 | E 1115/32 - 27  |                  |     |     |    |    |    |     |                 |    |                 |
|                  |    | 23   |    |    |    | 36  | E 1115/30 - 36  |    | E 1115/32 - 36  |                  |     |     |    |    |    |     |                 |    |                 |
|                  |    | 33   |    |    |    | 46  | E 1115/30 - 46  |    | E 1115/32 - 46  |                  |     |     |    |    |    |     |                 |    |                 |
|                  |    | 43   |    |    |    | 56  | E 1115/30 - 56  |    | E 1115/32 - 56  |                  |     |     |    |    |    |     |                 |    |                 |
|                  |    | 53   |    |    |    | 66  | E 1115/30 - 66  |    | E 1115/32 - 66  |                  |     |     |    |    |    |     |                 |    |                 |
|                  | 64 | 63   |    |    |    | 76  | E 1115/30 - 76  |    | E 1115/32 - 76  |                  |     |     |    |    |    |     |                 |    |                 |
|                  |    | 73   |    |    |    | 86  | E 1115/30 - 86  |    | E 1115/32 - 86  |                  |     |     |    |    |    |     |                 |    |                 |
|                  |    | 83   |    |    |    | 96  | E 1115/30 - 96  |    | E 1115/32 - 96  |                  |     |     |    |    |    |     |                 |    |                 |
|                  |    | 103  |    |    |    | 116 | E 1115/30 - 116 |    | E 1115/32 - 116 |                  |     |     |    |    |    |     |                 |    |                 |
|                  | 10 | 18   | 59 | 54 | 40 | 36  | E 1115/40 - 36  | 42 | E 1115/42 - 36  |                  |     |     |    |    |    |     |                 |    |                 |
|                  |    | 28   |    |    |    | 46  | E 1115/40 - 46  |    | E 1115/42 - 46  |                  |     |     |    |    |    |     |                 |    |                 |
|                  |    | 38   |    |    |    | 56  | E 1115/40 - 56  |    | E 1115/42 - 56  |                  |     |     |    |    |    |     |                 |    |                 |
|                  |    | 48   |    |    |    | 66  | E 1115/40 - 66  |    | E 1115/42 - 66  |                  |     |     |    |    |    |     |                 |    |                 |

1) l2: Ist keine Angabe für l2 (-) in der Tabelle vorhanden, gilt d2 H7 über die gesamte Buchsenlänge. / l2: If there is no specification for l2 (-) in the table, d2 H7 applies to the entire bush length of the guide bush.

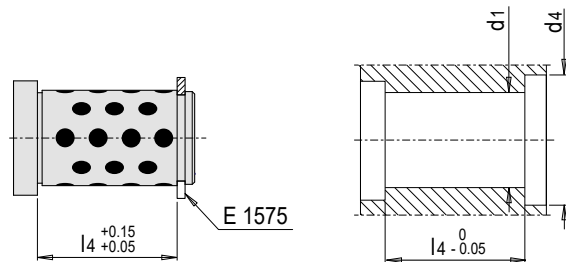

| d1 | d4   | E 1575    |
|----|------|-----------|
| 14 | 22   | E 1575/14 |
| 18 | 26.8 | E 1575/18 |
| 20 | 29   | E 1575/20 |
| 22 | 30.8 | E 1575/22 |
| 26 | 35.5 | E 1575/26 |
| 30 | 40.5 | E 1575/30 |
| 42 | 55.7 | E 1575/42 |
| 54 | 69.2 | E 1575/54 |
| 66 | 82.4 | E 1575/65 |

**i** Initialschmierung mit VGM 160  
Initial lubrication with VGM 160