

UMLENKBLECH, SELBSTSICHERND

SELF-LOCKING BAFFLE

- » Selbstsichernd durch Klemmstege am Blech
- » Positionierung durch Kerben in der Bohrung
- » Hoher Durchfluss dank dünnem Edelstahlblech von nur 1 mm Stärke

- » Self-locking due to clamping webs on the sheet
- » Positioning through grooves in the bore
- » High flow rate thanks to thin stainless steel sheet with a thickness of just 1 mm



meusbürger

Standards for your success.

E 21040



Umlenblech, selbstsichernd

Self-locking baffle

Typ A / Type A

Typ B / Type B

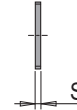
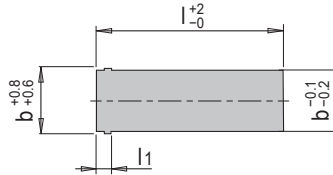
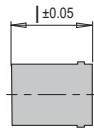

Mat.: 1.4301

t max. = 300 °C

s	l1	Typ / Type	b	l	Nr. / No.
1	3	A	6	14	E 21040/ 6/ 14
				100	E 21040/ 6/100
		B	6	200	E 21040/ 6/200
				16	E 21040/ 8/ 16
		A	8	100	E 21040/ 8/100
				200	E 21040/ 8/200
		B	8	18	E 21040/10/ 18
				100	E 21040/10/100
		A	10	200	E 21040/10/200
				20	E 21040/12/ 20
		B	10	100	E 21040/12/100
				200	E 21040/12/200
		A	12	22	E 21040/14/ 22
				100	E 21040/14/100
		B	12	200	E 21040/14/200
				24	E 21040/16/ 24
		A	14	150	E 21040/16/150
				300	E 21040/16/300
		B	14	26	E 21040/20/ 26
				150	E 21040/20/150
		A	16	300	E 21040/20/300
				28	E 21040/25/ 28
		B	16	150	E 21040/25/150
				300	E 21040/25/300

EINBAU

INSTALLATION

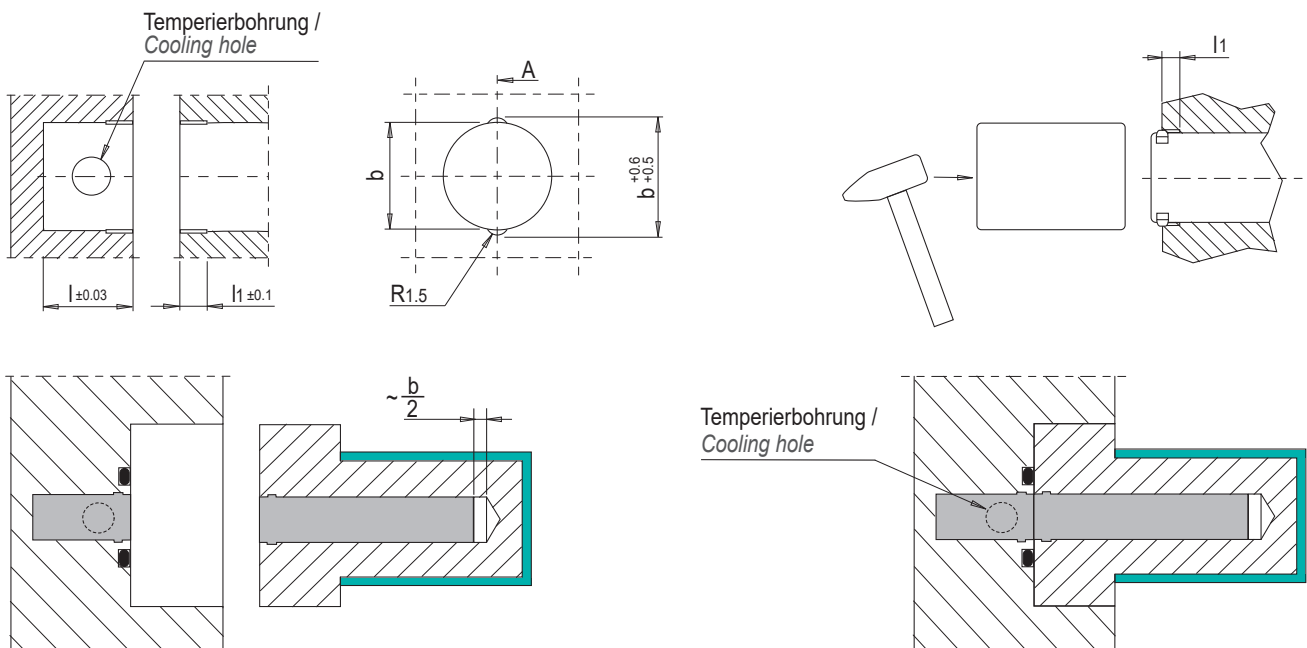

E 21041

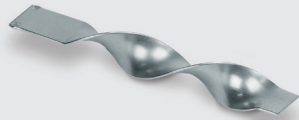

Umlenblech, selbstsichernd, spiralförmig

Self-locking spiral baffle

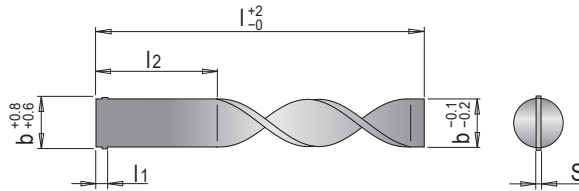

Mat.: 1.4301
2.0321 (MS) b 20, 25

t max. = 300 °C

s	l1	l2	b	l	Nr./No.
1	3	45	6	200	E 21041/ 6/200
			8		E 21041/ 8/200
			10		E 21041/10/200
		40	12		E 21041/12/200
			14		E 21041/14/200
			16		E 21041/16/300
1.5		55	20	300	E 21041/20/300
			25		E 21041/25/300

EINBAU

INSTALLATION

