

# Startloch- und Gewindeelektroden

## Electrodes for cutting starting holes and threads

- » Große Auswahl an Startlochelektroden in **Ein- und Mehrkanalausführung**
- » Gewinde-Elektroden für **metrische Gewinde und Whitworth-Rohrgewinde**
- » Alle Elektroden **sofort ab Lager** lieferbar
- » Wide range of electrodes for cutting starting holes, in **single- and multi-channel versions**
- » Electrodes for cutting **metric threads and Whitworth pipe threads**
- » All electrodes **immediately available from stock**



# V 93110



Gewindeelektrode, Kupfer, metrisch

Threaded electrode, copper, metric thread

» Für metrische Gewinde

» for metric threads

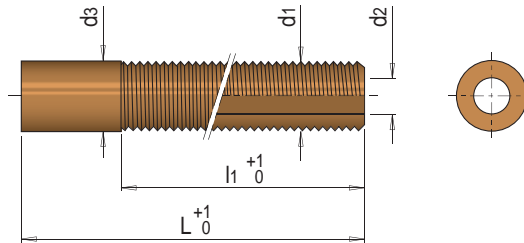

Mat.: 2.0060 (E-Cu 57)

L	d2	d3	d1	l1	Nr. /No.
80	0.7	3	M 3	50	V 93110/ 3 /50
			M 4		V 93110/ 4 /50
120	0.95	3.8	M 5	80	V 93110/ 5 /80
			M 6		V 93110/ 6 /80
	2.5	6	M 8		V 93110/ 8 /80
			M 8 x 0.75		V 93110/ 8 x 0.75/80
	4	8	M10		V 93110/10 /80
			M10 x 1.0		V 93110/10 x 1.0 /80
	5	10	M12		V 93110/12 x /80
	5.8	12	M14		V 93110/14 x /80
	7.5	14	M16		V 93110/16 x /80
			M16 x 1.5		V 93110/16 x 1.5 /80

# V 93120



Gewindeelektrode, Kupfer, Rohrgewinde

Threaded electrode, copper, pipe thread

» Für Rohrgewinde

» for pipe threads

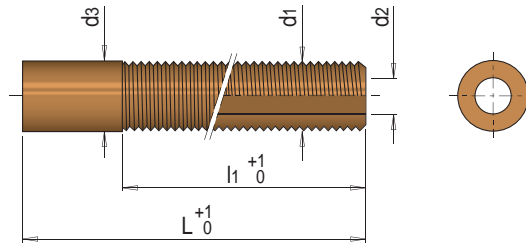

Mat.: 2.0060 (E-Cu 57)

L	d2	d3	d1	l1	Nr. /No.
120	4	8	G 1/8"	80	V 93120/1/8/80
	5	10	G 1/4"		V 93120/1/4/80
	7.5	14	G 3/8"		V 93120/3/8/80
	12	18	G 1/2"		V 93120/1/2/80
	10	20	G 3/4"		V 93120/3/4/80

V 93210



Rohrelektrode, Kupfer,  
Einkanal

Single-channel tube  
electrode, copper

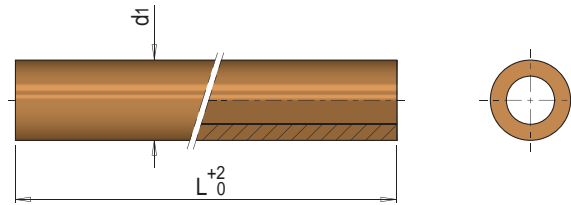

Verpackungseinheit: 1 Stk. = z.B. 20 Elektroden  
Packing unit: 1 pce. = for example 20 electrodes

Mat.: 2.0060 (E-Cu 57)

Stk. / Pcs.	d1	L	Nr. /No.	
20	0.3	300	V 93210/ 0.3 x 300	
	0.4		V 93210/ 0.4 x 300	
	0.5		V 93210/ 0.5 x 300	
	0.6		V 93210/ 0.6 x 300	
	0.7		V 93210/ 0.7 x 300	
	0.8		V 93210/ 0.8 x 300	
	0.9		V 93210/ 0.9 x 300	
	1.0		V 93210/ 1.0 x 300	
	10		1.2	V 93210/ 1.2 x 300
			1.5	V 93210/ 1.5 x 300
1.8			V 93210/ 1.8 x 300	
2.0			V 93210/ 2.0 x 300	
1	2.5		V 93210/ 2.5 x 300	
	3.0		V 93210/ 3.0 x 300	
	3.5		V 93210/ 3.5 x 300	
	4.0		V 93210/ 4.0 x 300	
	4.5		V 93210/ 4.5 x 300	
	5.0		V 93210/ 5.0 x 300	
	5.5		V 93210/ 5.5 x 300	
	6.0		V 93210/ 6.0 x 300	
	7.0	V 93210/ 7.0 x 300		
	8.0	V 93210/ 8.0 x 300		
	9.0	V 93210/ 9.0 x 300		
	10.0	V 93210/10.0 x 300		
	11.0	V 93210/11.0 x 300		
	12.0	V 93210/12.0 x 300		

V 93220



Rohrelektrode, Kupfer,  
Mehrkanal

Multi-channel tube  
electrode, copper

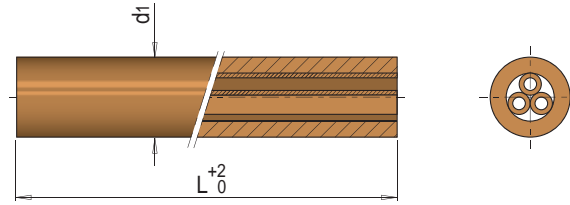

Verpackungseinheit: 1 Stk. = z.B. 20 Elektroden

Packing unit: 1 pce. = for example 20 electrodes

Mat.: 2.0060 (E-Cu 57)

Stk. / Pcs.	d1	L	Nr. /No.	
20	0.5	300	V 93220/ 0.5 x 300	
	0.6		V 93220/ 0.6 x 300	
	0.7		V 93220/ 0.7 x 300	
	0.8		V 93220/ 0.8 x 300	
	0.9		V 93220/ 0.9 x 300	
	1.0		V 93220/ 1.0 x 300	
10	1.2		V 93220/ 1.2 x 300	
	1.5		V 93220/ 1.5 x 300	
	1.8		V 93220/ 1.8 x 300	
	2.0		V 93220/ 2.0 x 300	
	1		2.5	V 93220/ 2.5 x 300
			3.0	V 93220/ 3.0 x 300
3.5			V 93220/ 3.5 x 300	
4.0			V 93220/ 4.0 x 300	
4.5			V 93220/ 4.5 x 300	
5.0			V 93220/ 5.0 x 300	
5.5			V 93220/ 5.5 x 300	
6.0			V 93220/ 6.0 x 300	
7.0			V 93220/ 7.0 x 300	
8.0			V 93220/ 8.0 x 300	
9.0		V 93220/ 9.0 x 300		
10.0		V 93220/10.0 x 300		
11.0	V 93220/11.0 x 300			
12.0	V 93220/12.0 x 300			